

WHEELHOUSE DECK

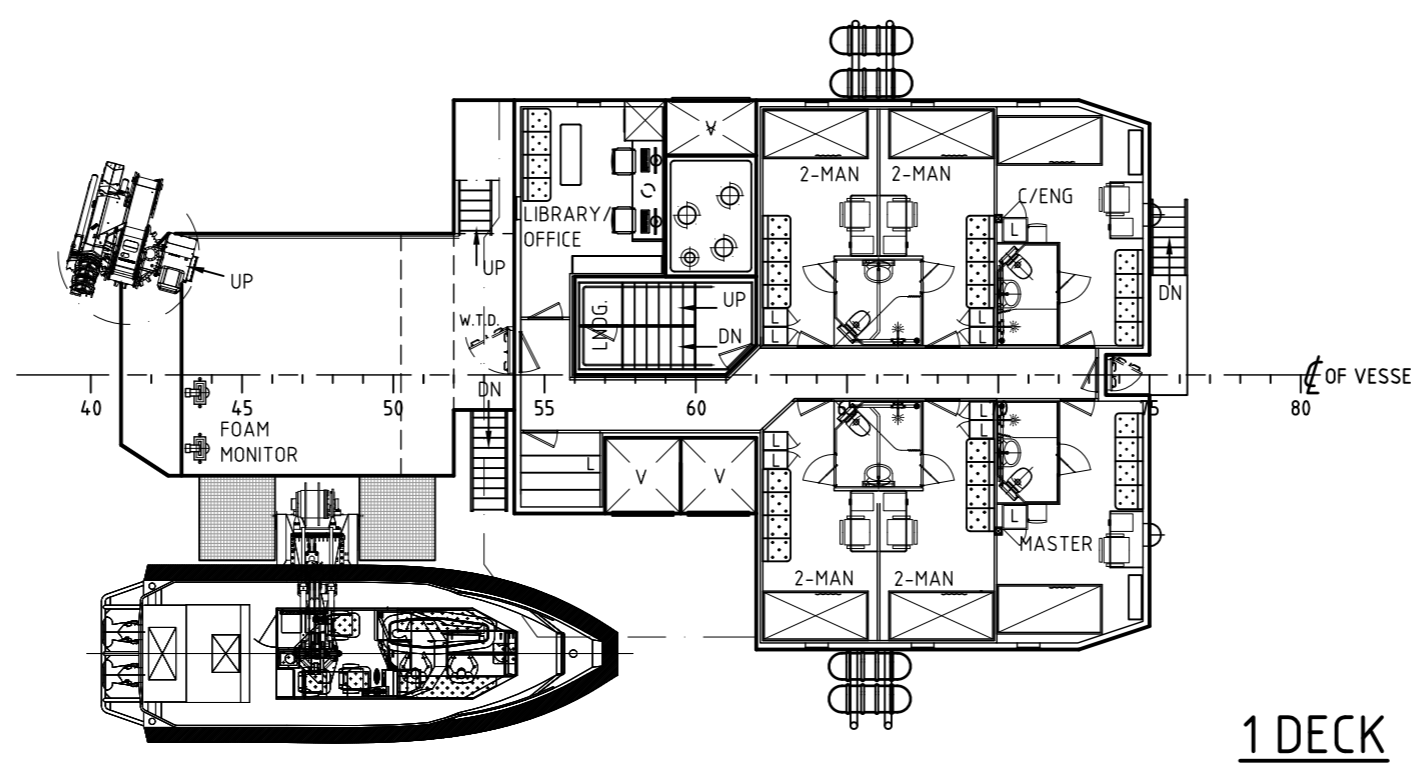

1 DECK
12 PERSONS

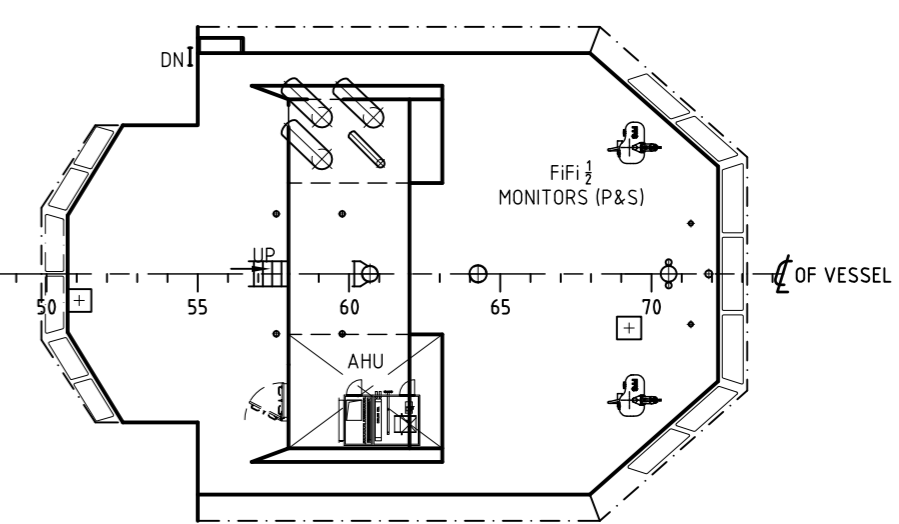

WHEELHOUSE TOP

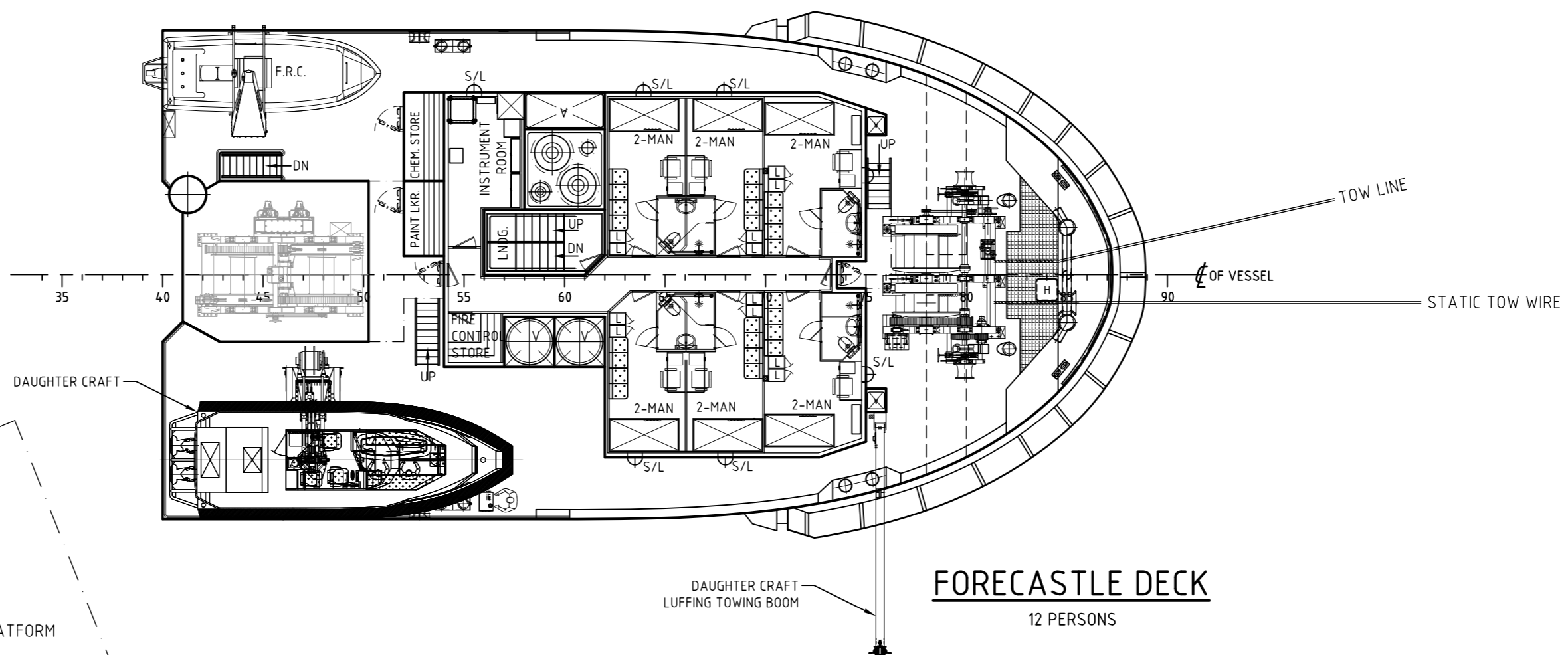

FORECASTLE DECK
12 PERSONS

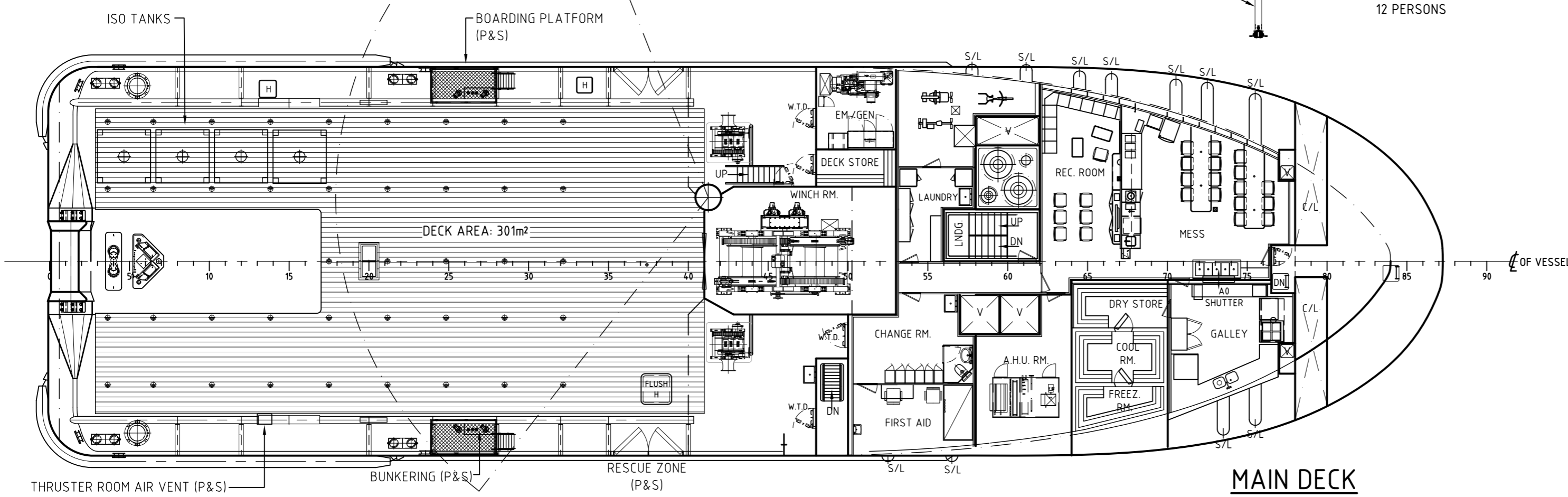

MAIN DECK

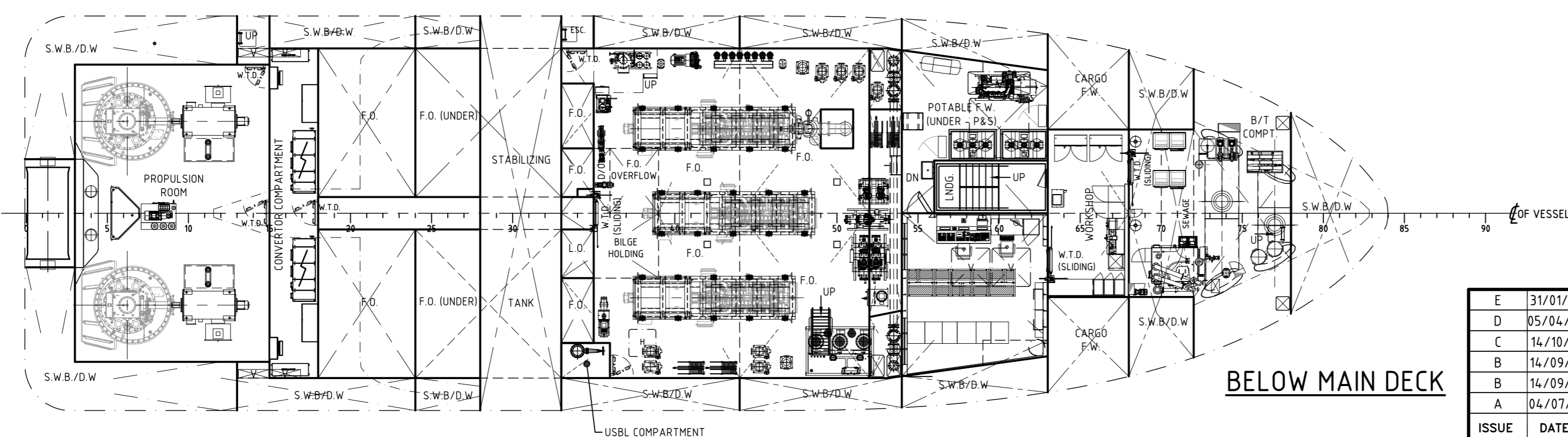

BELOW MAIN DECK

PRINCIPAL PARTICULARS

LENGTH (O.A.):	52.35m
LENGTH (W.L.):	49.53m
BREADTH:	14.60m
DEPTH (MLD.):	6.25m
DRAFT (MAX.):	4.90m (AT BASELINE)
COMPLEMENT:	22 PERSONS TOTAL

ISSUE	DATE	BY	REVISION	CLIENT APPROVAL
E	31/01/13	S.W.	ISSUED FOR APPROVAL - (ABS)	
D	05/04/12	S.W.	ISSUED FOR APPROVAL - (ABS)	
C	14/10/11	S.F.	ADDED PROC - ISSUED FOR INFORMATION - OWNER	
B	14/09/11	S.F.	ISSUED FOR APPROVAL - ABS	
B	14/09/11	S.F.	ISSUED FOR INFORMATION - SHIPYARD	
A	04/07/11	J.M.	ISSUED FOR CLIENT/OWNER REVIEW	

SHIP: 52.35m OFFTAKE SUPPORT VESSEL				
TITLE: GENERAL ARRANGEMENT				
OWNER	MERMAID MARINE AUSTRALIA LIMITED			
BUILDER	ASL SHIPYARD PTE. LTD.			YARD NO. 1040
CLASS	ABS *A1, OFFSHORE SUPPORT VESSEL, AH, @, *AMS, *ACCU, *DPS-2, ENVIRO, FIRE FIGHTING CAP			
		INTERNATIONAL MARITIME CONSULTANTS PTY. LTD. Naval Architects Marine Engineers Project Managers		
<small>SUITE 2, LEVEL 1 QUEENSGATE CENTRE, WILLIAM STREET, FREMANTLE, WESTERN AUSTRALIA 6160. TEL: 08 9335 1991, FAX: 08 9335 1995. E-MAIL: imc@internationalmaritime.com.au WEB: www.internationalmaritime.com.au</small>				
DRAWN	CHECKED	APPROVED	SCALE	DRAWING NO.
T.A.	J.M.	J.M.	1:150	11-507-001
24/6/11	31/01/13	31/01/13	A1	REV E

This drawing and all information shown hereon are the exclusive property of INTERNATIONAL MARITIME CONSULTANTS PTY. LTD. A.C.N 065 754 341 and is submitted only on a confidential basis. The recipient agrees not to reproduce the drawing, to return it upon request, and that no disclosure of the drawings or the information shown hereon will be made to a third party without the prior written consent from I.M.C.

This drawing has been produced under the controls established by a BVQI APPROVED QUALITY MANAGEMENT SYSTEM that conforms with ISO 9001:2000. BVQI Certificate Number: 129748

